

RK8-HLX-500

8-PORT HDMI/IR EXTENDER RACK OVER LAN



CONSOLIDATE UP TO EIGHT HDMI EXTENDERS WITH ONE RACK-MOUNTED TRANSMITTER UNIT THAT SENDS 1080P FULL HD SIGNALS UP TO 500 FEET OVER LAN

FEATURES

- Extends HDMI signals up to 500 feet via LAN (Cat5e/6 cables)
- Chainable for thousands of feet of extension
- Supports up to 8 HDMI sources on single rack
- Supports high resolution 1080p HD video, 1920x1080 at 60Hz
- Supports stereo audio
- IR (Infrared) remote enabled
- Rack mountable
- No software or driver required
- Plug-and-Play ready
- Distance can be increased if using ethernet GigaSwitch

APPLICATIONS

- Home Theater
- Corporate/Educational Presentations
- Call Centers
- Industrial (Long-Range Workstation Isolation)
- Information Terminals/Kiosks
- Airport Installations
(Air Traffic Control/Passenger Information)
- Educational Environments with Remote Displays



Designed and Manufactured in the USA

OVERVIEW

The RK8-HLX-500 is the perfect solution for extending HDMI signals to a remote location up to 500 feet away. It is the ideal way to consolidate up to eight HDMI signal sources in central one location.

The RK8-HLX-500 is rack-mountable, meaning it can fit into mounting shelves without the need for additional mounting equipment. It is capable of sending 1080p (1920x1080 @ 60Hz) Full HD HDMI signals to end-point displays in a variety of ranges and applications. One unit can extend to up to eight displays easily without the additional expense & power-costs of multiple extenders systems, making it the best choice for boosting the range of multiple HDMI source devices.

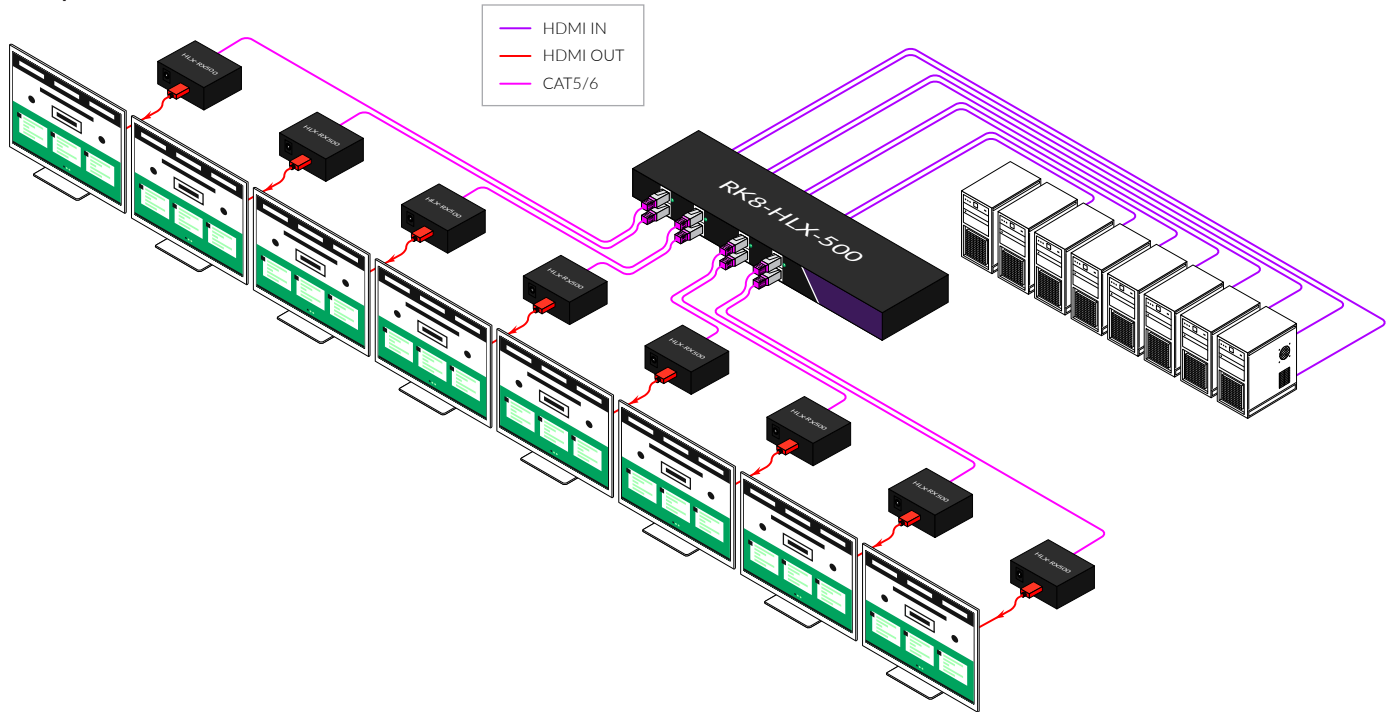

RACK TO ENDPOINT

If your company uses a rack to secure source devices like computer servers, DVD players, and other hardware, the RK8-HLX-500 allows you to run all of those components through one extension box. It supports up to eight HDMI input sources, centralizing entire set-ups from one convenient box. In the example shown above, HDMI signals are being routed from server rack through the RK8-HLX-500, which then sends them to multiple displays. Utilizing SmartAVI's HLX-500-RX receiver unit (sold separately), the system extends 500 feet over CAT5/5e/6 cables to end-point displays for perfect performance over extended ranges.

FRONT AND BACK



RK8-HLX-500 Front



RK8-HLX-500 Back

HLX-500-RX

The HLX-500-RX (sold separately) is the ideal receiver paired with the RK8-HLX-500. Compatible with gaming consoles, BluRay players, computer, and more, the HLX-500-RX receives excellent HDMI signals at resolutions up to 1080p (1920x1080 @ 60Hz) via inexpensive CAT5/5e/6 cables. This cost-effective extension and high quality output make the HLX-500-RX a great fit in theaters, schools, shopping centers, airports, hospitals, lobbies, and more. They are plug-and-play, meaning they are ready for use immediately upon connection to a power source, and require no additional software to manage; simply connect the receiver to an RK8-HLX-500 via CAT5/5e/6 cables, plug in a power source, and enjoy HD content from remote devices up to 500 feet away.



HLX-500-RX Front



HLX-500-RX Back

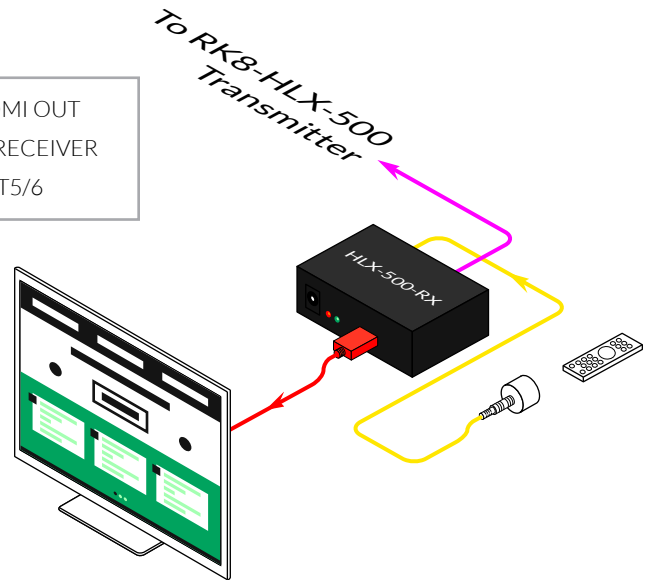
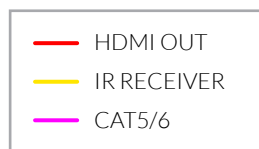

TECHNICAL SPECIFICATIONS	
Video Output	HDMI 1.3 and HDCP compliant
Resolution	1920 x 1200 @60Hz or 480p/720i/720p/1080i/1080p
Dimensions	4"W x 1"H x 4.357"D
Input	(1) RJ-45
Bandwidth	1.65 Gps
Power Adaptor	PS5VDC2A

TECHNICAL SPECIFICATIONS

VIDEO	
Format	HDMI 1.3 (HDCP compliant)
Resolution	Up to 1080p (1920x1080 @ 60Hz)
Input Interface	(8) HDMI Type A 19-pin (female)
Output Interface	(8) RJ-45 for CAT5/5e/6
Input Cable Length	Up to 40 ft
Output Cable Length	Up to 500 ft

AUDIO	
Format	HDMI (Dolby TrueHD, DTS-HD MA)
Input Interface	HDMI (Integrated)
Output Interface	CAT5/5e/6 via RJ-45

IR	
Signal Type	38 KHz
Interface	3.5 mm Jack Socket (Female)

OTHER	
Power	100-240 VAC (CCPWR06)
Dimensions	17" W x 1.7" H x 4.357" D
Weight	3.6 lbs
Approvals	UL, CE, ROHS Compliant
Operating Temperature	32 - 122° F (0 - 50 °C)
Storage Temperature	-4 - 149 ° F (-20 - 65 °C)
Humidity	Up to 90% (no condensation)

PART NO.	DESCRIPTION
RK8-HLX-500-S	HDMI & IR 8-Port Rackmount Extender Transmitter over LAN or CAT5/5e/6 Cable.. Includes: [RK8-HLX-500 and CCPWR06]
HLX-RX500	HDMI, IR, RS-232 Point to Point CAT5 Receiver. Includes: [HLX-RX500, PS5VD2A]

www.smartavi.com

Tel: (800) AVI-2131 • (702) 800-0005
 2455 W Cheyenne Ave, Suite 112
 North Las Vegas, NV 89032

Smart-AVI
 SMART AUDIO VIDEO INNOVATION